

Sink Base Cabinets Assembly Instructions

Important: When attaching two cabinets together, pre drill holes on the face frame to avoid material split.

This assembly instruction applies to **SB30 SB33 SB36 SB42**

Parts included:

	Item	Qt
A	Face Frame with Door	1
B	Side Panel (Left and Right)	2
C	Bottom	1
D	Bottom Back Brace	1

	Item	Qt
E	Top Back Brace	1
F	Toe Kick	1
G	Corner Braces	4
H	1/2" Corner Brace Screws	8

Step by step

1. Check and count the items in the box before your installation. If you are short any pieces, stop and call the supplier. Otherwise, follow the steps below.
2. Put the face frame (A) face down on a flat soft working surface (Figure 1).
3. Install side panels (Figure 2): insert right and left side panels (B) into the grooves of face frame (A) and align the cam lock connectors (Figure 2). Lock the cam lock with a screwdriver by turning the screw 180 degree clockwise (Figure 4).
4. Install the bottom (Figure 3): gently spread side panels and insert bottom (C) into the grooves of side panel (B) until it touches the face frame (A). Lock each cam lock.
5. Install the back Braces and toe kick (Figure 5): put the top back brace (E) and bottom back brace at rear of side panel (B) (Figure 5). Well align them and lock each cam lock. Install the toe kick by locking the cam lock at both ends (Figure 5).
6. Install Corner Braces (Figure 6): place the Corner Braces on each top corner of the cabinet and secure them with 1/2" Corner Brace screws.

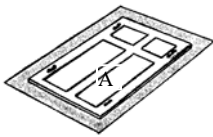

Figure 1

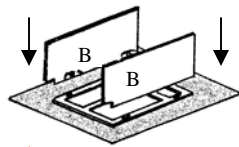

Figure 2

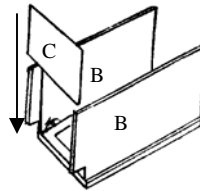

Figure 3

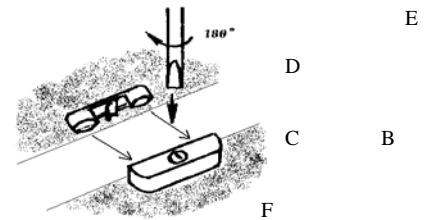

Figure 4

Figure 5

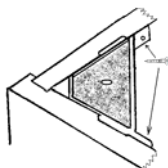

Figure 6

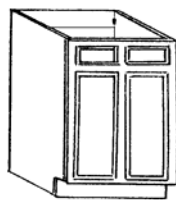

Figure 7