

## Wall Cabinets Assembly Instructions

**Important:** When attaching two cabinets together, pre drill holes on the face frame to avoid material split.

This assembly instruction applies to the single and double door wall cabinets (**Items: W0930 W1230 W1530 W1830 W2130 W2430 W2730 W3030 W3330 W3630 W4230 W1242 W1542 W1842 W2142 W2442 W2742 W3042 W3342 W3642 W4242 W4842 W3012 W3612 W2415 W3015 W3315 W3615 W3018 W3318 W3618 W3024 W3624 W3027 W3327 W3627 WBC2730**).

Parts included:

	Item	Qt
A	Face Frame	1
B	Side Panel	2
C	Bottom	1
D	Top	1
E	Back Panel	1
	Door	1

	Item	Qt
F	Shelf Clips	8
G	Shelves	2
H	¾" Back Panel Screws	4
I	Screw Anchor	4
J	2" Wall Mount Screws	4

### Step by step

1. Check and count the items in the box before your installation. If you are short any pieces, stop and call the supplier. Otherwise, follow the steps below.
2. Put the face frame (A) face down on a flat soft working surface (Figure 1).
3. Install side panels: insert right and left side panels (B) into the grooves of face frame (A) and align the cam lock connectors (Figure 2). Lock the cam lock with a screwdriver by turning the screw 180 degree clockwise (Figure 3).
4. Install the top and bottom: gently spread side panels and insert top (D) and bottom (C) into the grooves of side panel (B) until they touch the face frame (A) (Figure 4). Align them and lock each cam lock (Figure 3).
5. Install the back panel: insert and slide the back panel (E) into groove in rear of side panel (B) (Figure 5). Align the back panel (E) and enforce it with 4 ¾" Back Panel screws (H) into the predrilled holes on the back panel.
6. Install the shelves (For **W3015, W3615** and **W3018**, ignore this step): insert the shelf clips (F) into the holes on the side panels at the desired height and slide in the shelves (G).
7. Place the "L" brackets into the corner of the face frame and the side panels at top and bottom of cabinet. Then fasten the screws to them as Figure 7.

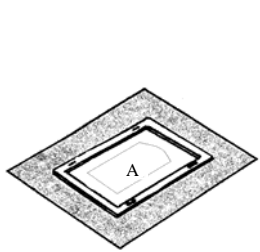

Figure 1.

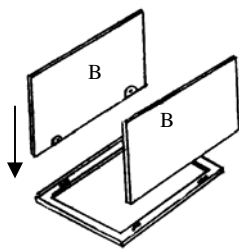

Figure 2.

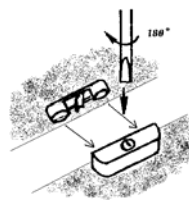

Figure 3.

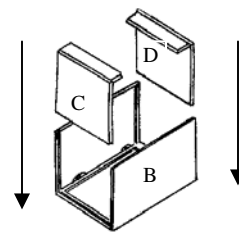

Figure 4.

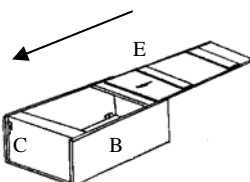

Figure 5.

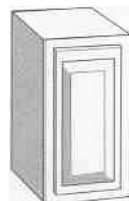

Figure 6.

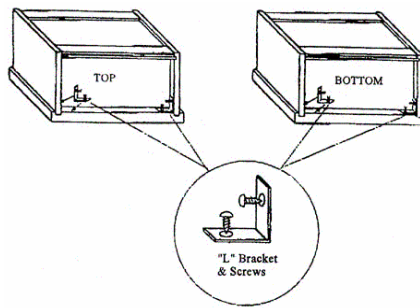

Figure 7.