

Blind Wall Cabinet

Step-by-Step Assembly Instructions

Code	Item	Qty
A	RIGHT/LEFT SIDE PANEL	2
D	TOP/BOTTOM PANEL	1
G	SHELF	2/3
H	BACK PANEL	1
M	FRONT FACE	1

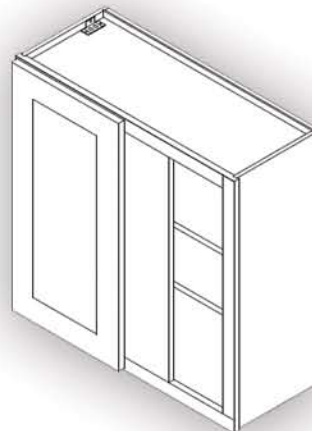

Step 1a

➤ Insert opposite A into metal clips of both D's

➤ Lay A flat; grooves facing up and insert both D's into metal clips of A (refer to Metal Clip System)

Easy Assembly - Metal Clip System - Easy Assembly

➤ Align clips **1** and **2**

➤ Slide **1** into **2**

➤ Insert locking screw into clip pair

➤ Tighten all screws

Step 1b

➤ Slide H into D R/L

Step 3

➤ Screw screws through H into D Top/Bottom

Step 2

➤ Attach M to A & D so that the metal clips engage (refer to Metal Clip System)

Step 4

➤ Insert shelf clips into D, slide G, and secure