

# Wall Cabinet With Shelves

## Step-by-Step Assembly Instructions

Code	Item	Qty
A	RIGHT/LEFT SIDE PANEL	2
D	BOTTOM PANEL	1
G	SHELF	1/2/3
H	BACK PANEL	1
M	FRONT FACE	1

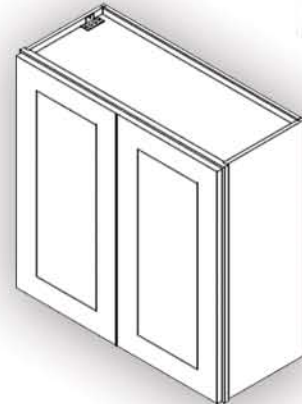

**Step 1a**

➤ Insert opposite A into metal clips of both D's

➤ Lay A flat; grooves facing up and insert both D's into metal clips of A (refer to Metal Clip System)

**-Easy Assembly- Metal Clip System -Easy Assembly-**

➤ Align clips **1** and **2**

➤ Slide **1** into **2**

➤ Insert locking screw into clip pair

➤ Tighten all screws

**Step 1b**

➤ Slide H into D R/L

**Step 3**

➤ Screw screws through H into D Top/Bottom

**Step 2**

➤ Attach M to A & D so that the metal clips engage (refer to Metal Clip System)

**Step 4**

➤ Insert shelf clips into D, slide G, and secure