

## Corner Sink Front Assembly Instructions

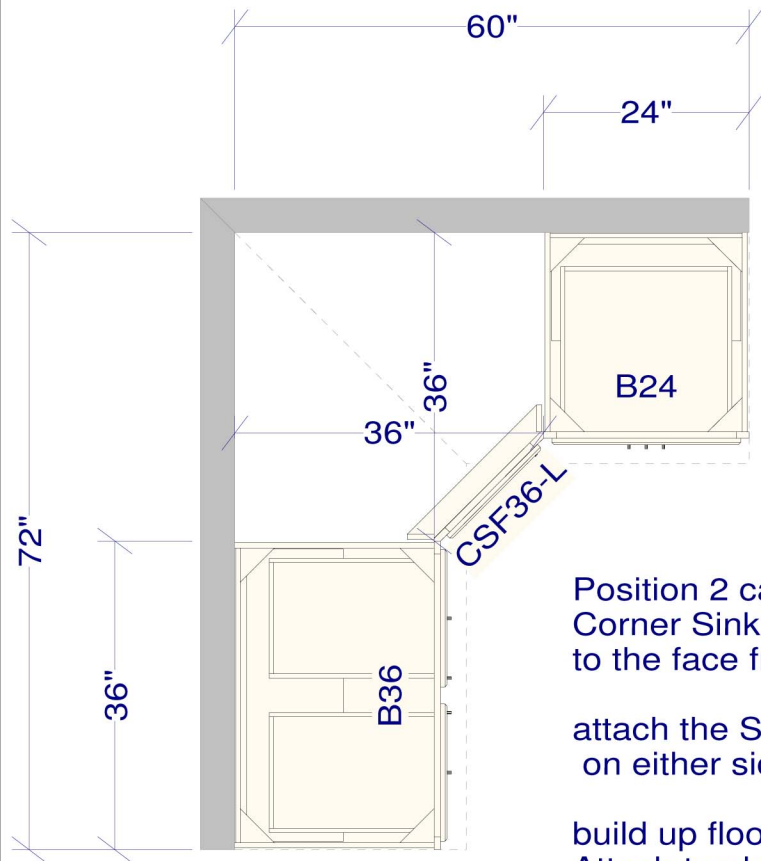

Corner Sink Front consists of front frame with door attached floor kit including toe kick (3 piece set)

Position 2 cabinets on either side of the Corner Sink Front 36" from the wall to the face frame as shown

attach the Sink front to the face frame of both cabinets on either side

build up floor 4.5" with 2x4's and lay down floor on top  
Attach toe kick