

VANITY No Drawers

ASSEMBLY INSTRUCTIONS

CODE	ITEM	QTY
A	Right Left Side Panel	2
D	Bottom Panel	1
H	Back Panel	1
J	Toe Kick Plate	1
M	Front Face	1
S	Support Bracket	4

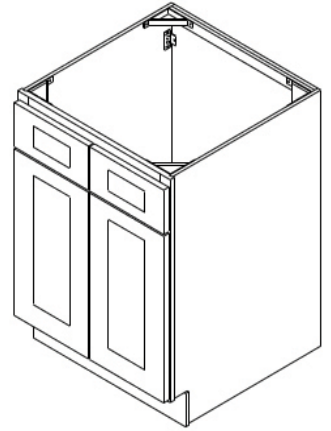

EASY ASSEMBLY METAL CLIP SYSTEM



- Align Clips ① and ②
- Slide ① into ②
- Insert locking screw into clip pair
- Tighten all screws

STEP 1

- Lay H flat; grooves facing upward
- Insert A into metal clips of H (refer to Metal Clip System)

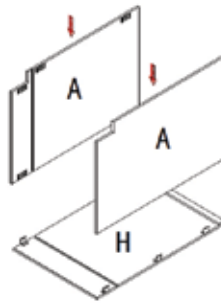

STEP 2

- Slide D into grooves of A

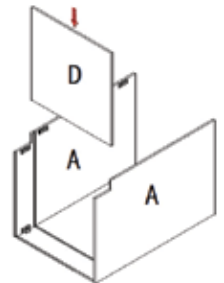

STEP 3

- Attach M onto D and A (refer to Metal Clip System)
- Attach J onto bottom front of A using the Metal Clip System

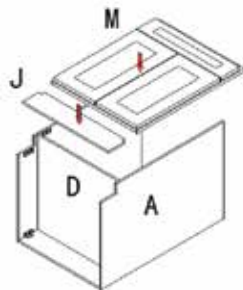

STEP 4

- Place and screw S (plastic brackets) into corners of M, A, and H

