

# CORNER SINK FRONT

ASSEMBLY INSTRUCTIONS

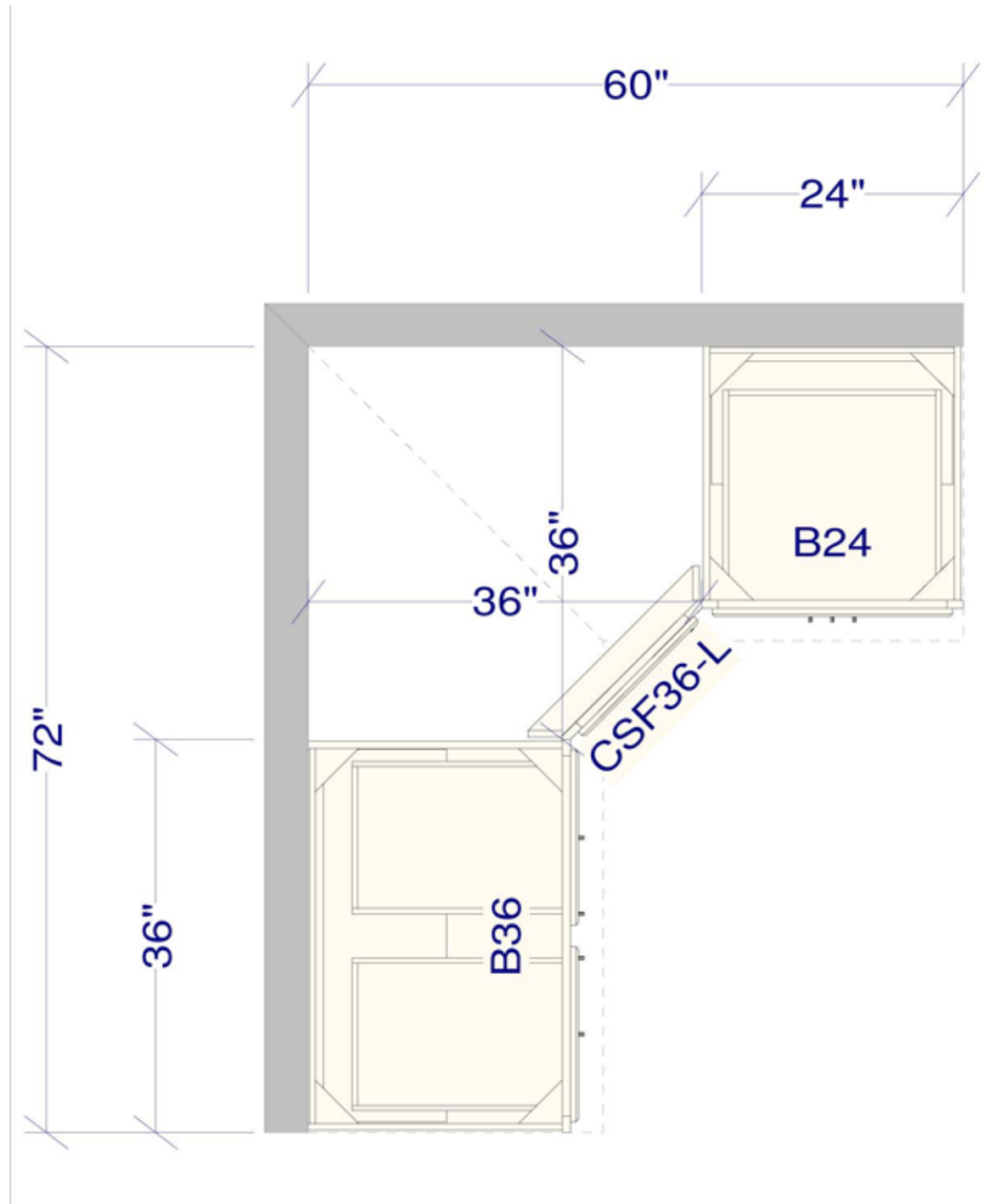

Corner Sink Front consists of front frame with door attached floor kit including toe kick (3 piece set)

Position 2 cabinets on either side of the Corner Sink Front 36" from the wall to the face frame as show. Attach the Sink Front to the face frame of both cabinets on either side.

Build up floor 4.5" with 2X4's and lay down floor ontop. Attach toe kick.